



Safe drinking water. Anywhere. Anytime.

Classic 3

Safe drinking water
Anywhere. Anytime.



Hydro-Photon, Inc.
PO Box 675
262 Ellsworth Road
Blue Hill, ME 04614 USA
Toll Free USA: 888-SteriPEN
(+1) 207-374-5800
info@steripen.com
www.steripen.com

SPPF.UG-E.140407

©2014 Hydro-Photon, Inc.

THANK YOU FOR PURCHASING THE BEST-SELLING PORTABLE UV PURIFIER

Thanks for choosing the SteriPEN Classic 3 and congratulations on your purchase!

Classic 3 is built to be safe, simple and straightforward. If after reading this guide, you have any questions or your SteriPEN doesn't operate as described in this manual, please contact us. We love hearing from you! We are here to troubleshoot and make sure you have a working device. Call 888-826-6234 or email support@steripen.com.

Also, be sure to visit us online and register your Classic 3 for all the latest news and special deals.

Thanks again and happy travels!

P.S. Don't forget to recycle the packaging!



www.steripen.com
facebook.com/steripen
@steripen

EASY TO USE



1 Remove lamp cover.

Twist cover gently and pull away from lamp. Take care to keep the water sensor pins dry prior to activating.

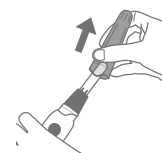

2 Press activation button.

Once for half-liter treatment, twice for liter treatment. LED(s) will flash green to indicate unit is ready.



3 Submerge in clear water and stir.

When water sensor pins detect water, lamp will illuminate. When treatment is complete and successful, lamp will turn off and green indicator(s) will flash.

A flashing or steady red indicator means treatment was unsuccessful. See "Classic 3 LED Indicator Guide."

Be sure to wipe bottle threads dry before drinking.

CLASSIC 3's ANATOMY

- 1 Battery cap
- 2 Indicator LEDs
- 3 Activation button
- 4 Water sensor pins
- 5 UV lamp
- 6 Lamp cover



Specifications

Treatment size: ½ or 1 liter

Treatment time: 48 or 90 seconds

Lamp life: 8,000 activations

Number of liter treatments per set of batteries: (numbers are approximate)
lithium - 150
alkaline - 50
rechargeable - 100

Minimum bottle opening: 22mm

Weight: 83g

Weight with batteries: Lithium: 141g;
Alkaline: 178g; Rechargeable: 191g

Length with lamp cover: 186mm

Maximum diameter: 43mm

BATTERY GUIDE



Remove battery cap by rotating counterclockwise so that cap arrow points to open lock icon.

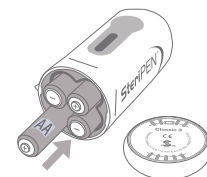

Install AA batteries with polarities as shown in battery compartment. For best performance, replace all batteries at the same time.



Replace battery cap by aligning cap with open lock icon. Then, rotate cap clockwise until arrow points to closed lock icon.

Classic 3 runs on disposable **alkaline batteries**, **lithium batteries**, or **rechargeable nickel metal hydride (NiMH) AA batteries** with a 2300mAh capacity.

For best results, always use quality, name brand batteries, like Energizer® or Sanyo Eneloop®.

CARE & CLEANING

While Classic 3's battery compartment is designed to be highly water-resistant, it is not waterproof. Avoid submerging Classic 3's battery end in water.

Classic 3's battery performance may be adversely affected by cold weather. In temperatures below 32°F/0°C carry the unit close to your body or warm up batteries before use. If batteries are too cold, Classic 3's LED indicator may give low battery signal. Warm up batteries and treat again.

Make sure to wipe dry after each use.

When not in use, Classic 3 should be kept in a safe place that is clean and dry. It should not be exposed to temperatures above 120°F/49°C or below -4°F/-20°C. Also, when storing for long periods of time, remove batteries to keep them from inadvertently draining.

To clean Classic 3, wash with a soft cloth and a mild soap solution. Rinse soap from device and dry with a clean, soft cloth.

If Classic 3's bulb is cracked, chipped or damaged, don't use it. Return it to the store or contact SteriPEN for repair. Email us at support@steripen.com or call 888-826-6234 for help. *Do not try to fix it yourself.*

CLASSIC 3 LED INDICATOR GUIDE

The Classic 3's three LED indicator lights let you know the status of your SteriPEN and the water purification process. Green blinking LED(s) indicates successful water treatment. The red LED indicates unsuccessful water treatment, low battery level, battery replacement needed, or UV lamp replacement needed.



LED RHYTHMS

(One liter = two green LEDs, half liter = one green LED.)

LED Rhythm	Meaning	Status
Two green LEDs (flashing)	Successful water treatment	SUCCESSFUL
Two green LEDs (solid)	Successful water treatment, batteries low	SUCCESSFUL
Two green LEDs (solid), one red LED (solid)	Successful water treatment, UV lamp good for less than 100 uses	SUCCESSFUL
Two green LEDs (solid), one red LED (solid)	Not submerged in water in time	UNSUCCESSFUL
Two red LEDs (solid)	Replace or recharge batteries	UNSUCCESSFUL
Two red LEDs (solid)	Water not detected	UNSUCCESSFUL
Two red LEDs (solid), one green LED (solid)	Replace UV lamp, UV lamp damaged	UNSUCCESSFUL

If LED indicators show normal signals, but the lamp does not illuminate, **do not consume**. Contact SteriPEN support.

TIPS FOR SAFE USE

Classic 3 is intended for use, and is most effective in **clear** water but can also be used to treat turbid, murky or cloudy water in an emergency. By doubling treatment time (treating the volume of water twice), Classic 3 can treat water that might be described as: “*much closer to clear than opaque,*” “*obviously not clear,*” “*obviously cloudy,*” “*objects viewed through the water are visible but slightly blurry,*” or “*as cloudy as weak lemonade.*” For best UV purification results, if the water is less clear, filter it first with the SteriPEN® PreFilter, FitsAll Filter® or other method.

Classic 3 is not designed to treat volumes of water larger than one liter. If more than one liter needs treatment, the water should be divided into ½ liter and one liter volumes and treated separately.

When operating properly, the UV lamp will emit visible light as well as UV light. If the lamp is not emitting visible light, it is not functioning properly and should not be used until it has been repaired.

Agitation of water by stirring Classic 3 or rocking the container is necessary, as it promotes uniform purification.

Classic 3 is not intended to purify water above the surface of the water in the container, such as droplets on the sides of the container.

Classic 3 is not intended to purify surfaces of a drinking container, like the mouth of the bottle. Be certain that you always wipe the bottle's mouth dry with a clean, dry cloth before drinking.

Classic 3 may be used in glass, plastic, ceramic, or metal containers, as they all absorb or reflect UV light, thereby shielding the user from UV exposure.

Classic 3 is not intended for use by children.

Classic 3 is a high voltage device. Removal or tampering with the electronic circuit board or lamp assembly may cause injury, or damage. Do not open, expose, modify, or touch internal circuitry; doing so can lead to high voltage shock.

As with other fluorescent-type lamps, Classic 3 contains a small amount of mercury. At the end of its life, please dispose of Classic 3 properly. For specific instructions contact your local waste disposal organization.

Classic 3 is not intended to treat liquids other than water. Do not use in water with ice. Do not use in water above 120°F/49°C.

As with any other water treatment system, always have a backup method.

While carefully controlled microbiological testing of all SteriPEN products has been conducted, use of all SteriPEN products in the field may produce results that vary from our laboratory test data.

CAUTION

If the equipment is used in a manner not specified by the manufacturer, the protection provided by the equipment may be impaired.

Do not attempt to bypass water sensor; it is an important safety feature.

Do not handle SteriPEN with wet hands; do not touch water sensor pins with wet fingers.

⚠ **This device emits UV light, direct exposure may be harmful.**

⚠ **Do not use UV lamp as a light source.**

⚠ **Do not use near skin, eyes, or insert into bodily orifices.**

PRE-FILTER'S ANATOMY

Pre-Filter removes large particles, such as leaves, twigs, sand and other debris for improved UV purification effectiveness. The Pre-Filter is not intended to be a purification method.

To store Pre-Filter, insert filter cartridge with air vent pointing down and rotate clockwise to lock in place.

Fits most wide-mouthed bottles, like Nalgene®.

- 1 Air vent (not for drinking)
- 2 Filter cartridge
- 3 Pre-Filter base
- 4 Bottle gasket

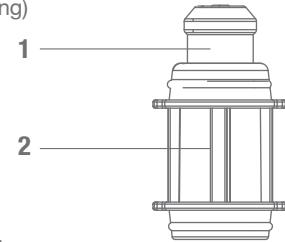

Specifications

Nominal filter size: 40 microns

Weight: 45g

47.5 x 67.9mm diameter

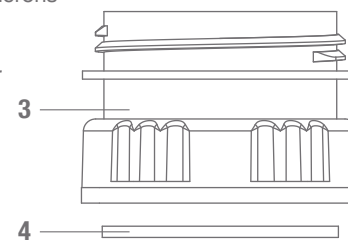

USING THE PRE-FILTER



1 Screw Pre-Filter onto bottle

Insert cartridge and pull blue air vent open.

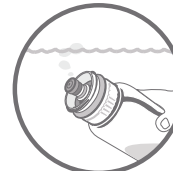

2 Filter water

Pour through or submerge bottle until filled.

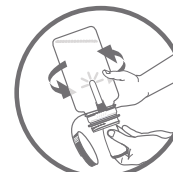

3 Remove cartridge and purify

Activate SteriPEN, then insert into Pre-Filter and invert bottle.

For best results, wet filter cartridge before filling to improve water flow. Rub the mesh with a clean cloth until it becomes thoroughly saturated.

Remove Pre-Filter before drinking.

Air vent is not intended for use as a mouthpiece.

SteriPEN does not treat water droplets on the Pre-Filter's body or threads. Be sure to wipe dry any wet surfaces before drinking.

FREQUENTLY ASKED QUESTIONS

Get in touch! We are always happy to hear from you: email support@steripen.com, call 888-826-6234 or visit www.steripen.com.

It looks like the tip of Classic 3's lamp is melting — is this normal?

What you are seeing is a small bead of silicone used as a shock absorber to protect the lamp.

Classic 3's lamp lasts for 8,000 treatments. What happens when I reach 8,000?

Classic 3's LED indicator will flash red three times then green once to indicate that its bulb is exhausted. Contact us to have it replaced.

Classic 3's bulb is shining a purple, rather than blue light — is it still working?

Yes. The visible light indicates that the bulb is working regardless of its color.

Can I take Classic 3 on a plane?

Yes. Classic 3 and all SteriPEN products are allowed in carry-on bags, as well as checked luggage. Classic 3 will work in any country to destroy bacteria, viruses and protozoa.

Does altitude affect Classic 3's ability to purify water?

No. SteriPEN technology and product design have been tested and used on Mount Everest for years.

Can I use Classic 3 to treat more than 1 liter at a time?

No, we do not recommend it. Classic 3's effectiveness is ONLY tested and certified for volumes up to 1 liter. You can, however treat and combine multiple 1-liter volumes of water.

What about parasites like worms and their eggs? Does Classic 3 treat for them?

Due to our animal testing policies, Classic 3's effectiveness against such parasites has not been certified.

Can Classic 3 treat soda? Iced tea? Juice?

No. UV light may not effectively destroy microbes in beverages other than water.

Are some SteriPEN models more effective than others?

No. All SteriPEN models operate using a lamp which emits UV light and they are all equally effective in purifying water.

Why does my SteriPEN indicate my rechargeable batteries are low when I haven't yet treated the projected number of liters?

Rechargeable, NiMH batteries may give a premature low battery signal. See specifications for the number of liters you should expect to treat with high quality, fully charged NiMH batteries.

PATENTED & CERTIFIED

SteriPEN® technology is patented in the USA with further U.S. patents pending and patents pending worldwide. SteriPEN® is a registered trademark of Hydro-Photon, Inc. U.S. Patent Numbers 5,900,212; 6,110,424; 6,579,495; and 8,362,432.

Compliance testing of SteriPEN Classic 3 for the CE mark and BV logo was successfully completed by Bureau Veritas.

Conforms to UL Std 61010-1

Certified to CSA Std C22.2 No. 61010-1



Water Quality Association: SteriPEN® tested and Gold Seal certified by WQA against U.S. EPA Microbiological Water Purifier Standard.

THE FINE PRINT

Directions for Use 40 C.F.R. §156.10(i)(2)

It is a violation of Federal law to use this product in a manner inconsistent with its labeling.

40 C.F.R. §156.10(i)(2)(ii)

SteriPEN® exceeds U.S. EPA Guide Standard and Protocol for Testing Microbiological Water Purifiers, destroying over 99.9999% of bacteria, 99.99% of viruses, and 99.9% of protozoa when used as directed. SteriPEN® is not a sterilizer.

3-year warranty for any manufacturing defect. For product registration and complete warranty information, please visit www.steripen.com/warranty or contact your local distributor.

While carefully controlled microbiological testing of Classic 3 has been conducted, use in the field may produce results that vary from our laboratory test data.

This device complies with Part 15 of the FCC Rules.

Operation is subject to the following two conditions:

1. This device may not cause harmful interference, and
2. This device must accept any interference received, including interference that may cause undesired operation.

CAN ICES-3(B)/NMB-3(B)

NOTE: This equipment has been tested and found to comply with the limits for a Class B digital device, pursuant to Part 15 of the FCC Rules. These limits are designed to provide reasonable protection against harmful interference in a residential installation. This equipment generates, uses and can radiate radio frequency energy and, if not installed and used in accordance with the instructions, may cause harmful interference to radio communications. However, there is no guarantee that interference will not occur in a particular installation. If this equipment does cause harmful interference to radio or television reception, which can be determined by turning the equipment off and on, the user is encouraged to try to correct the interference by one or more of the following measures:

- Reorient or relocate the receiving antenna.
- Increase the separation between the equipment and receiver.
- Connect the equipment into an outlet on a circuit different from that to which the receiver is connected.
- Consult the dealer or an experienced radio/TV technician for help.

Warning: Changes or modifications to this unit not expressly approved by the party responsible for compliance could void the user authority to operate the equipment under FCC rules.

